



www.jindalrealty.com

Phase-I: Par completion granted for an area admeasuring 93.562 Acres by DG, TCP, Haryana Video Memo No. LC-2062-PA(B)-2016/4904 dated 10/03/2016 | **Phase-II:** RERA Regd. No. 149 of 2017 | **Phase-III:** RERA Regd. No. 165 of 2017 dated 29.08.2017 | **Phase-V:** RERA Regd. No. 243 of 2021 dated 18.06.2021

Disclaimer: All information, images and visuals, drawings, plans, or sketches shown in this brochure are only an architect's impression, purely conceptual, representative images or artistic renderings and not to scale. Nothing contained herein intends to constitute a legal offer and does not form part of any legally binding agreement and/or commitment of any nature. The Company endeavours to keep the information up to date and correct. Recipients/viewers are advised to exercise their discretion in relying on the information shown/provided and are requested to verify all the details, including area, amenities, services, terms of sales and payments and other relevant terms independently with the Sales Team/Company, have thorough understanding of the same and take appropriate advice prior to concluding any decision for buying any Unit(s) in the Project.



Invest in Education and
Healthcare in the fast
emerging economic hub,
Sonipat.





Close to the proposed high speed RRTS



10-20 minutes drive to other industrial hubs like Kundli Industrial Area, Rai Industrial Area & Barhi Industrial Area



25 minutes drive to Asia's largest upcoming EV car plant at IMT Kharkhoda (with Maruti & more than 40 ancillary companies like Minda, JBM and others)



5 minutes drive to Haryana Orbit Rail Corridor (Harsana Kalan)

Sonipat is geared for transformation.

Sonipat, a rising economic hub in Haryana's NCR region, is emerging as a key economic centre due to strong infrastructure and industrial growth. Its location along NH-44, NH-334B and the KMP Expressway ensures excellent Delhi connectivity, soon to improve further with the Metro and RRTS.

The Sonipat Master Plan 2031 and inclusion in the DMIC support major industrial and residential expansion. Smart parks, logistics hubs, and public investment are attracting businesses.

Institutions like OP Jindal Global University, Ashoka University and IIIT Sonipat supply skilled talent, while government MSME initiatives boost entrepreneurship. Together, these factors are transforming Sonipat into a regional economic powerhouse.

* As per government infrastructure



The O.P. Jindal Global University is committed to nurturing the next generation of leaders who will make a positive impact on society. Offering a diverse range of academic programmes, its faculty comprises distinguished scholars and practitioners from around the globe.

Actual Image



A Lifestyle Beyond Compare.

Life at Jindal Global City is about more than just great infrastructure—it's about experiences that enrich daily living. Thoughtfully planned spaces encourage a sense of community, while world-class amenities cater to modern needs. Green open spaces, walking trails, recreational zones, and wellness-focused facilities create a holistic living environment.

From exclusive social hub and sports facilities to serene parks that offer a retreat from the urban rush, every element is designed to elevate your lifestyle. Whether you're enjoying a morning walk, connecting with like-minded neighbours, or simply unwinding in the tranquility of nature, life here is about comfort, luxury, and well-being.



Actual Image



Actual Image

Jindal Global City – A Future with Unmatched Living, Learning, and Prosperity.

Growing Population Drives Rising Demand for Schools and Healthcare.

At the heart of Sonipat's growth, Jindal Global City exemplifies modern, sustainable living. Spread across 214 acres in Sectors 33, 34 and 35, this premium plotted development offers a harmonious blend of urban convenience and green serenity.

Strategically situated near renowned educational and healthcare institutions, this township serves as a vital catchment area for families seeking quality services. Currently, more than 1,000 families reside within Jindal Global City, contributing to a growing community with diverse needs. Sonipat's population is steadily increasing, driving strong demand for top-tier schools, coaching centres, hospitals, and specialty clinics. This rising demand ensures continuous development of educational and healthcare infrastructure within and around this township, making it ideal for residents prioritizing access to essential services alongside a premium living environment.



Jindal Global City

Big Catchment, Smart Investment.

- **Sonipat**, emerging as a **key economic hub**.
- Strong infrastructure and industrial growth.
- **1000+ Families** already living in Jindal Global City.
- **13.25 Million sq. feet** already developed.
- **Ideally located** on Sonipat - Narela Road, along NH-44, NH-334B and the KMP Expressway.
- **Excellent connectivity** with all regions of NCR; Delhi just 20 minutes away.
- **Poised for even better connectivity** with the Delhi Metro extending to Sonipat and upcoming RRTS.
- Township with premium residential plots of sizes **250 to 1000 sq. yds.***
- **20 acres*** dedicated to planned green spaces.

* Sizes may vary as per actual site development and planning.

KEY DISTANCES & DURATION*

Roads	
334-B	01 min
NH44	05 min
Eastern Peripheral Expressway & Western Peripheral Expressway	10 mins
UER-II	20 min
Rail	
Haryana Orbital Rail Corridor	05 min
Airports	
IGI Airport	90 mins
Jewar Airport	120 mins
Industrial Hubs	
Rai Industrial	10 mins
Kundli Industrial	15 mins
Barhi Industrail	20 mins
Kharkhoda	20 mins
Cities	
Delhi	20 mins
Rohtak	40 mins
Panipat	40 mins

*Depends on traffic conditions.



Come home to
a lavish lifestyle.



Premium plots available
for education institutes
and nursing home in
Jindal Global City.

- SCHOOLS
- NURSING HOME
- ROADS
- PLOTS
- GREEN BELTS
- CANAL

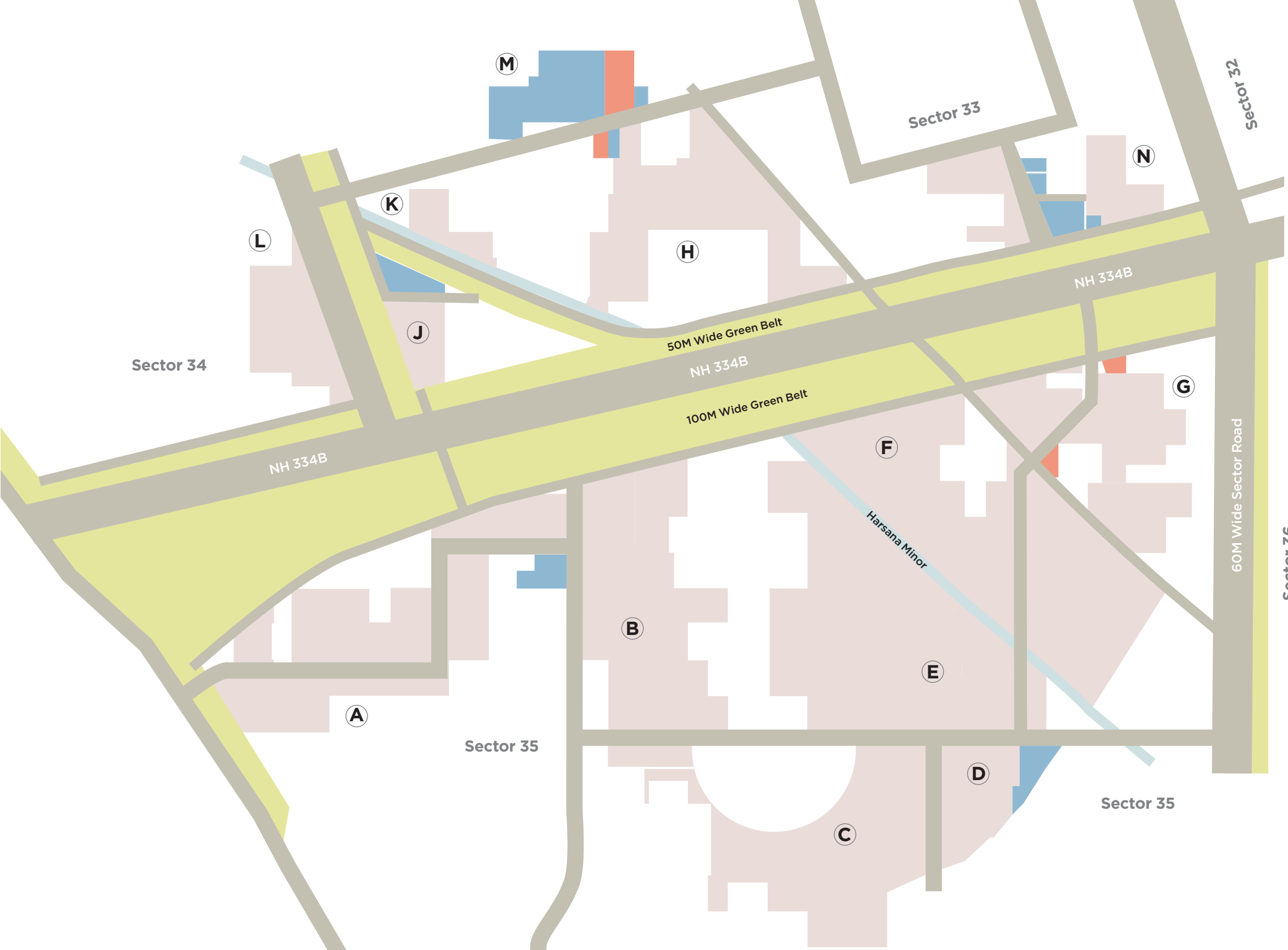

Education to foster the minds of
the leaders of tomorrow.

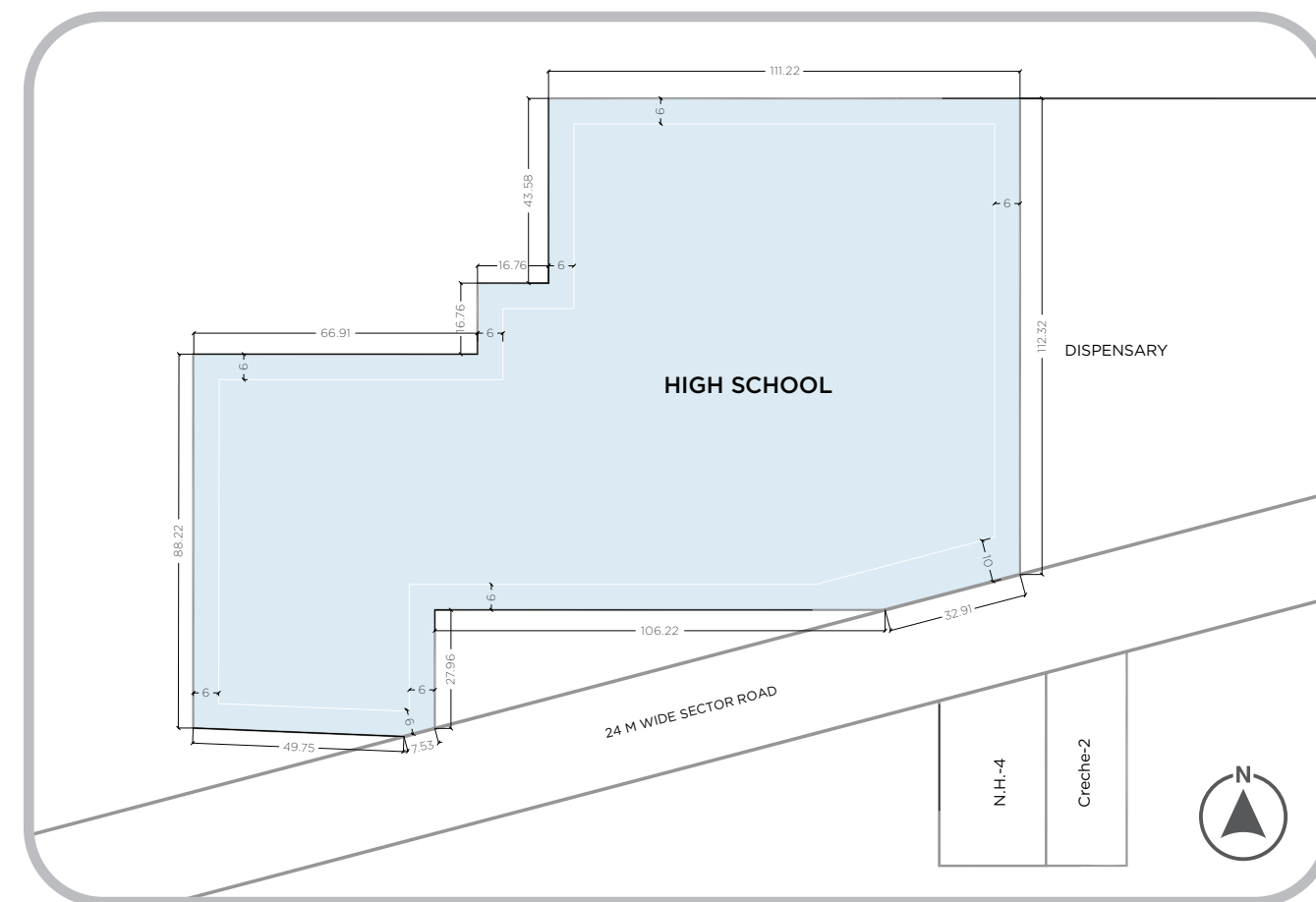
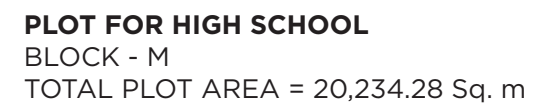
A group of four people, two adults and two students, are gathered around a laptop, smiling and looking at the screen. The setting is a bright room with large windows in the background. The two adults, a man and a woman, are standing and leaning over the laptop. The two students, a girl and a boy, are sitting at the table. They are all wearing white shirts and ties. The laptop is open on the table. The background shows a large window with a grid pattern, letting in natural light. The overall atmosphere is positive and collaborative.

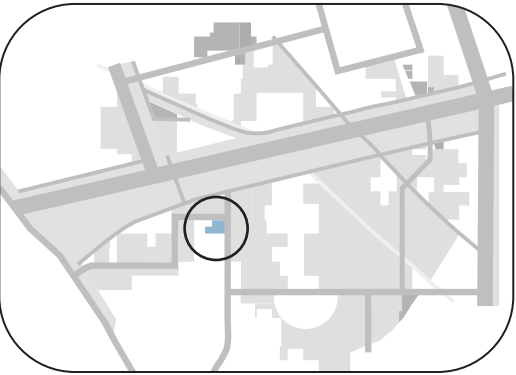

BLOCK - A
TOTAL PLOT AREA = 4,156.12 Sq. m

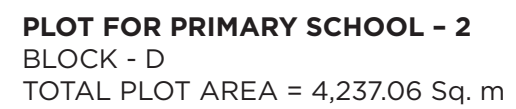



PLOT FOR PRIMARY SCHOOL - 3
BLOCK - J
TOTAL PLOT AREA = 4,334.18 Sq. m

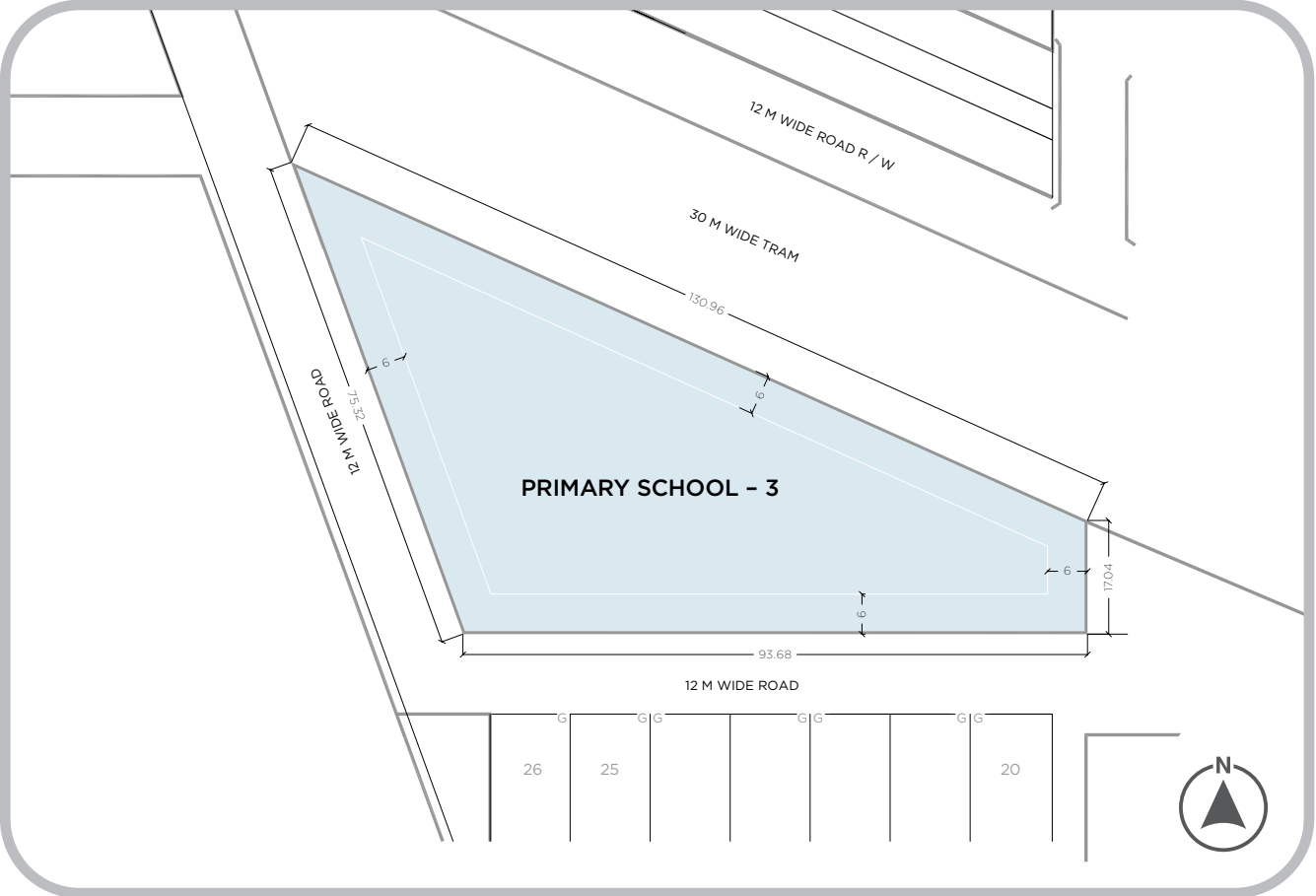

PLOT FOR PRIMARY SCHOOL - 4
BLOCK - N
TOTAL PLOT AREA = 4,160.17 Sq. m

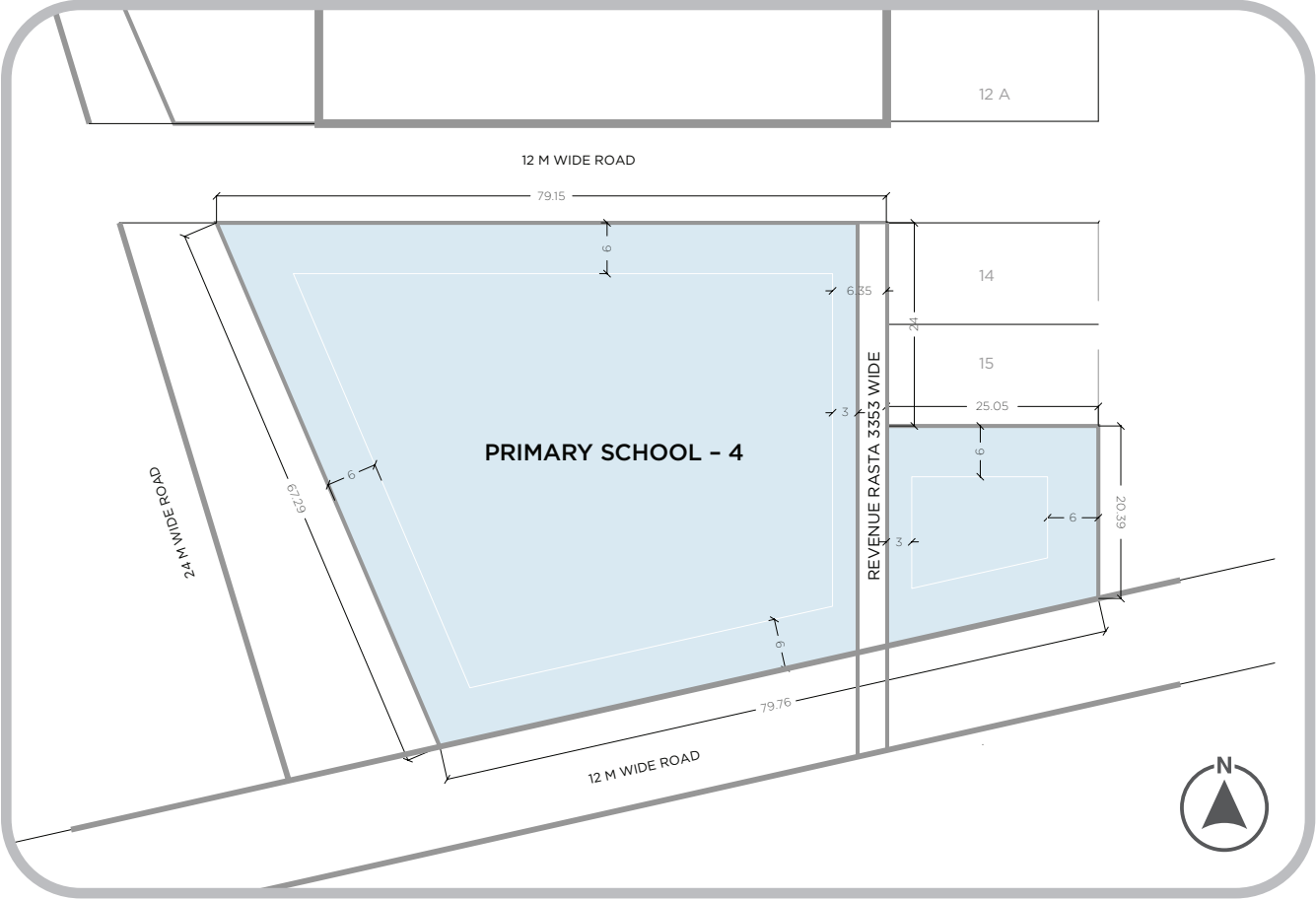
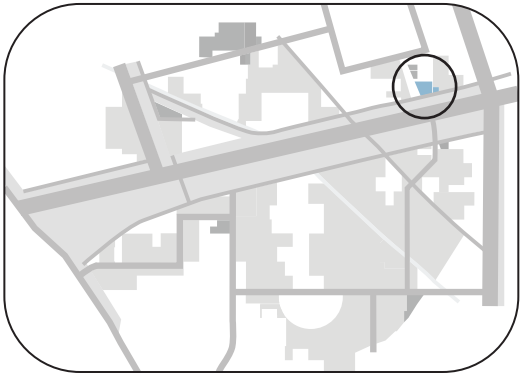

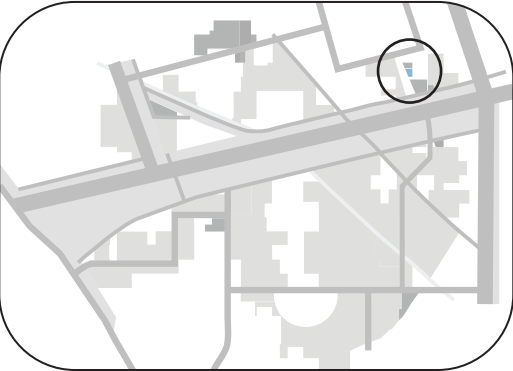

PLOT FOR NURSERY SCHOOL - 3
BLOCK - N
TOTAL PLOT AREA = 910.54 Sq. m

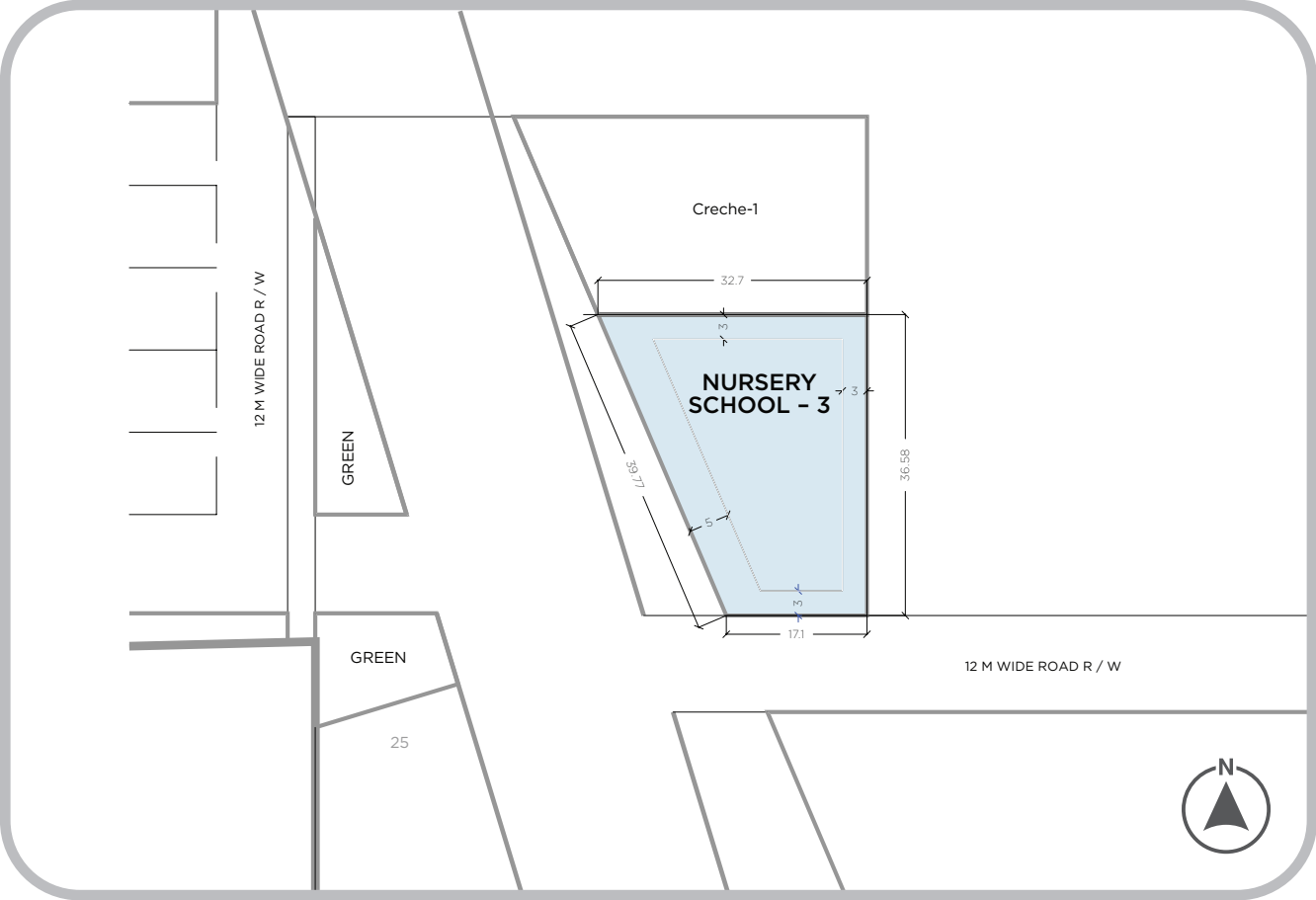

PLOT FOR NURSERY SCHOOL - 4
BLOCK - M
TOTAL PLOT AREA = 829.61 Sq. m

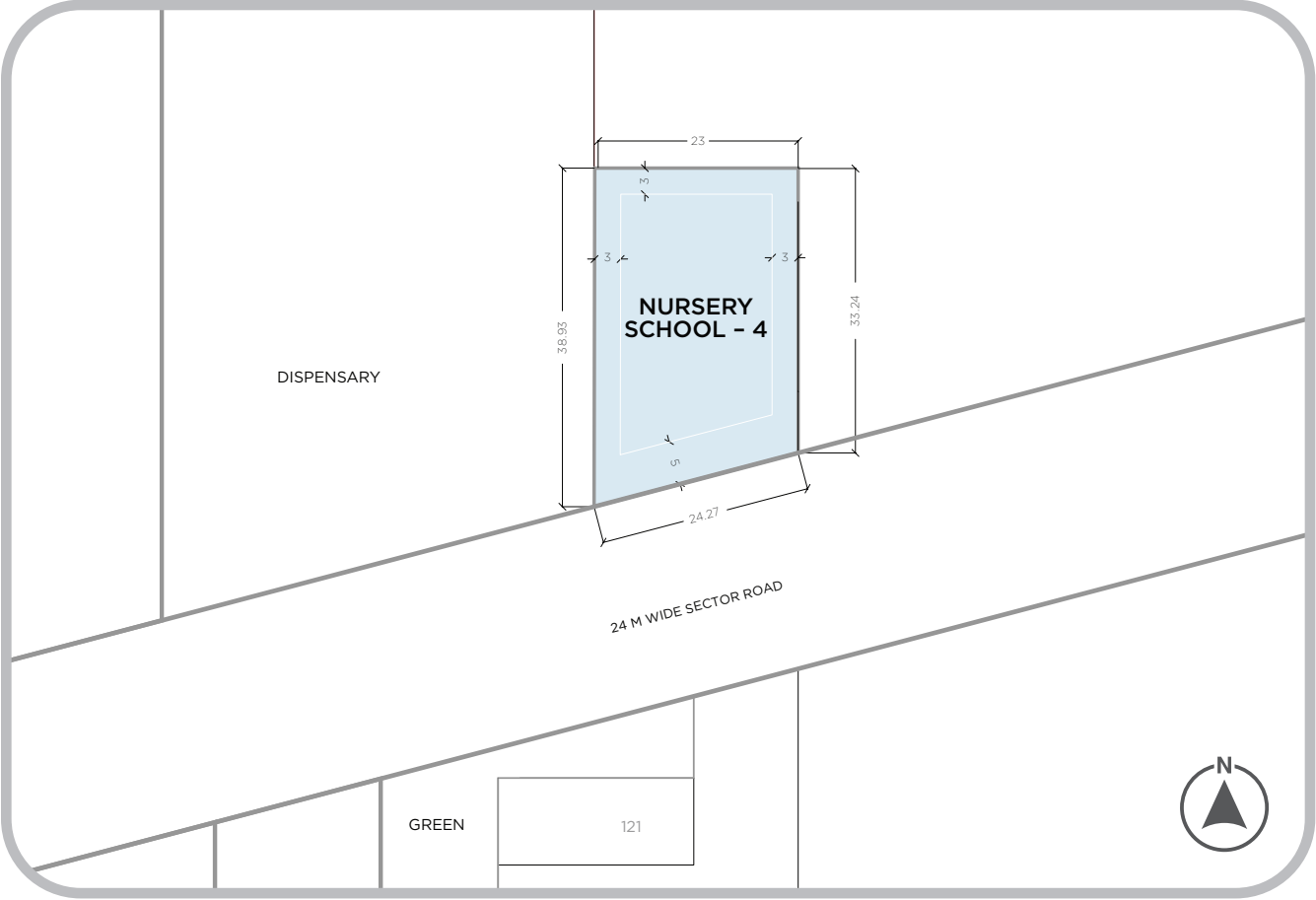
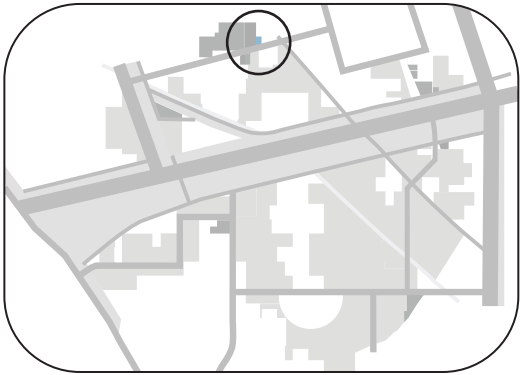

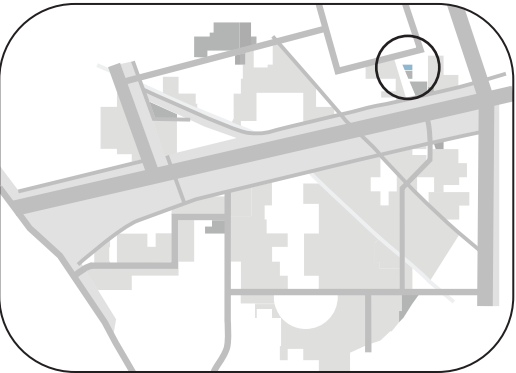

PLOT FOR CRECHE - 1
BLOCK - N
TOTAL PLOT AREA = 910.54 Sq. m

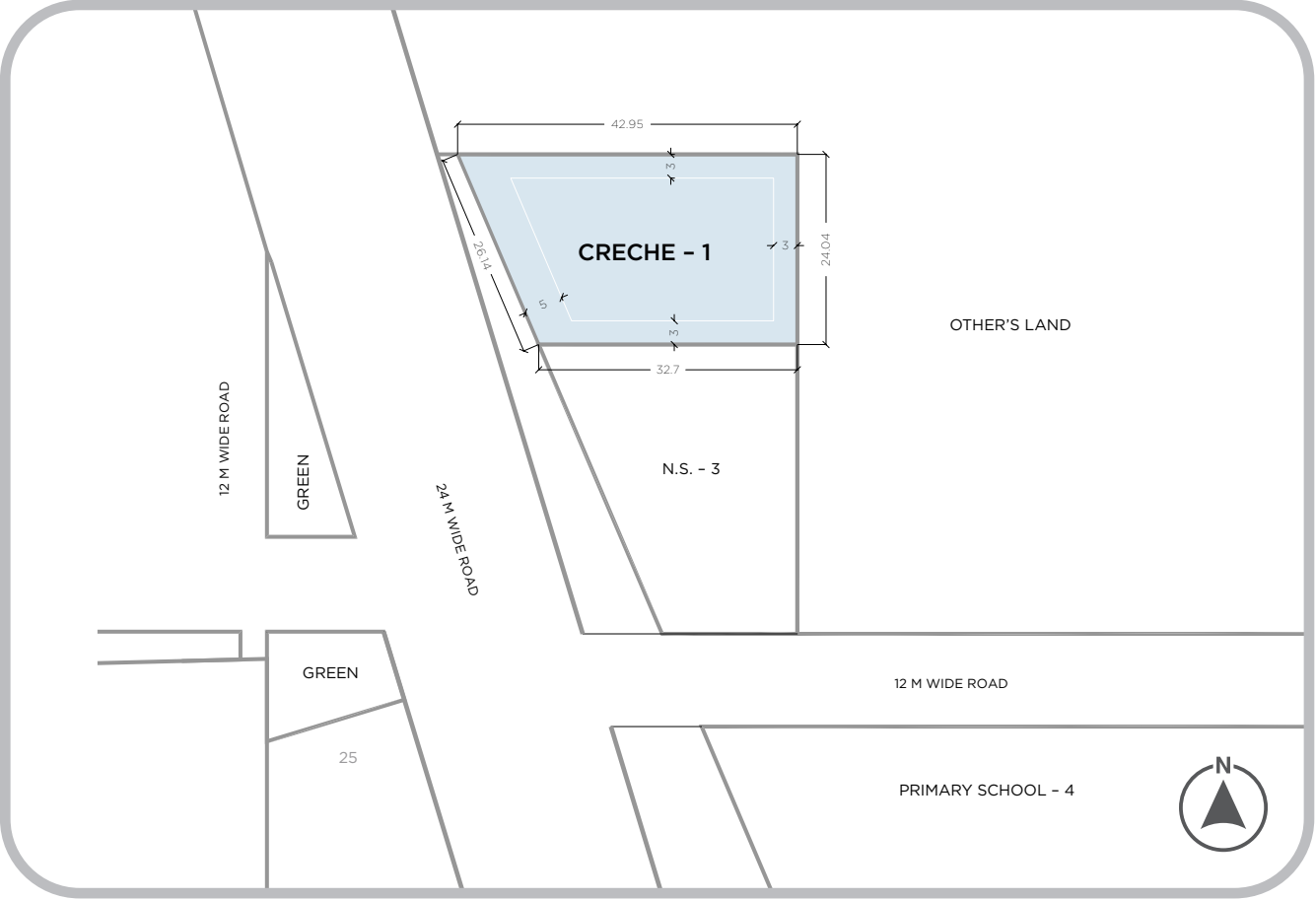

PLOT FOR CRECHE - 2
BLOCK - H
TOTAL PLOT AREA = 914.59 Sq. m

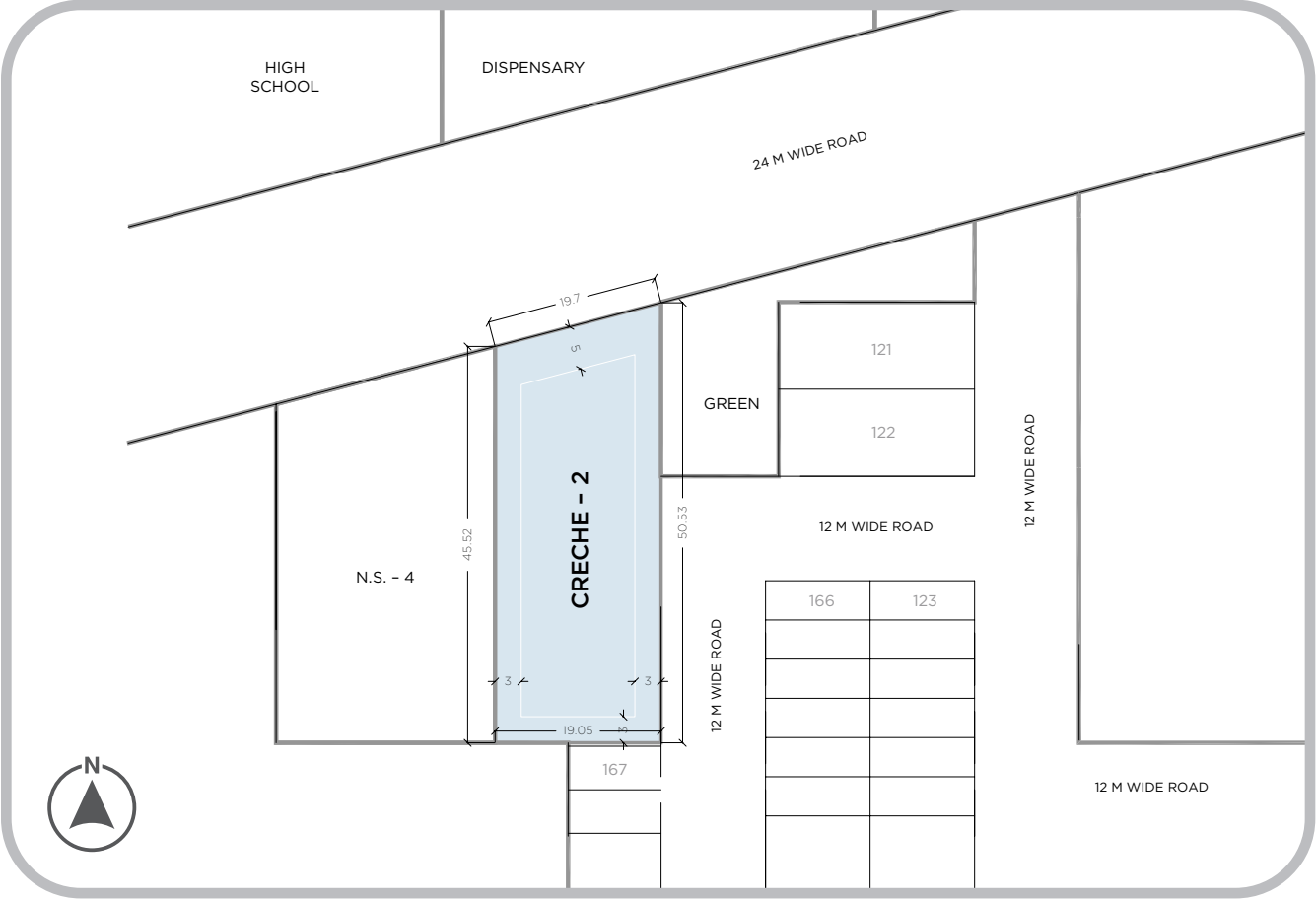
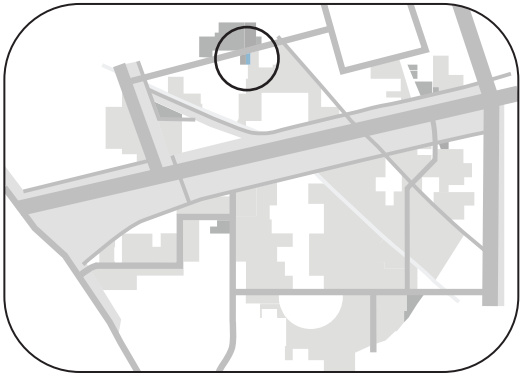

A Nation's strength
lies in its health.



PLOT FOR DISPENSARY
BLOCK - M
TOTAL PLOT AREA = 5,058.57 Sq. m

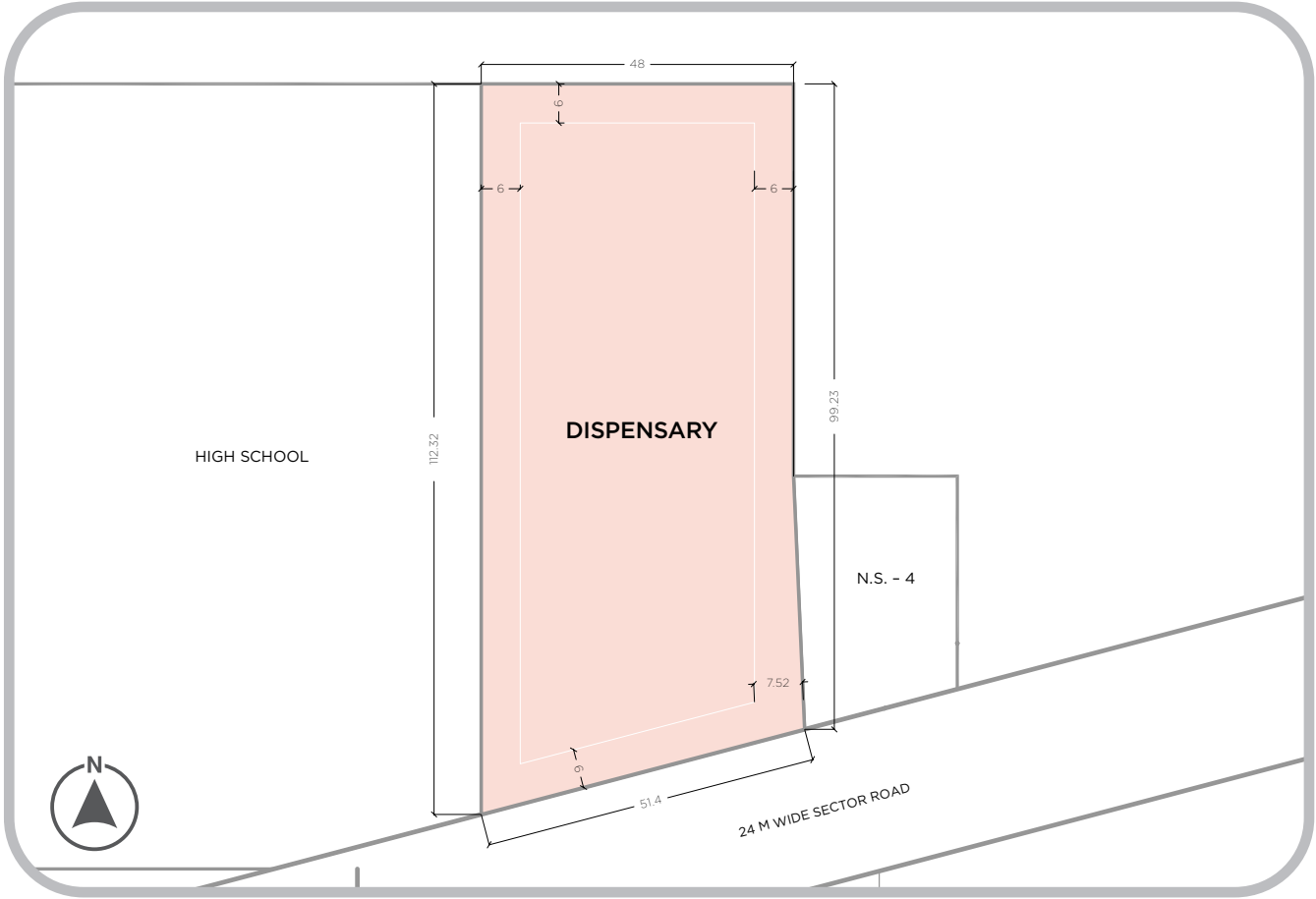

PLOT FOR NURSING HOME - 2
BLOCK - G
TOTAL PLOT AREA = 1,108.84 Sq. m

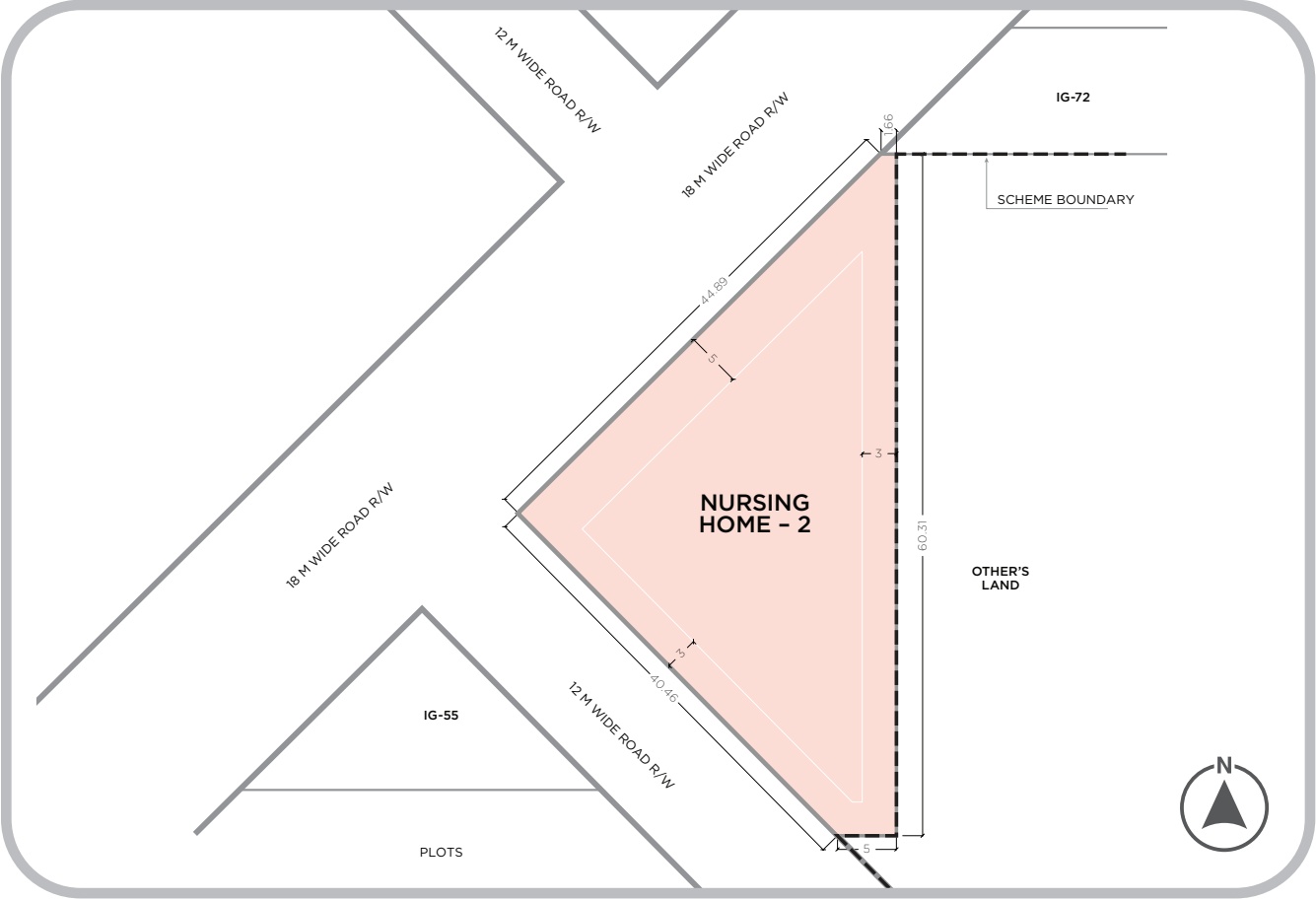
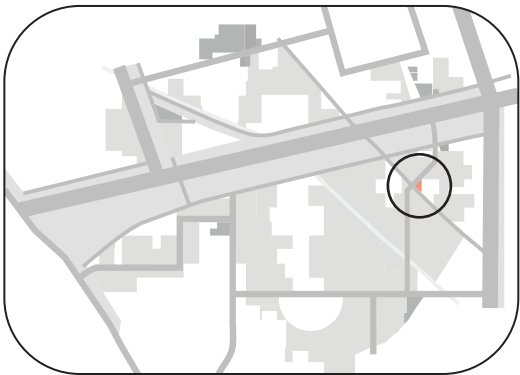



PLOT FOR NURSING HOME - 3
BLOCK - G
TOTAL PLOT AREA = 1,104.78 Sq. m

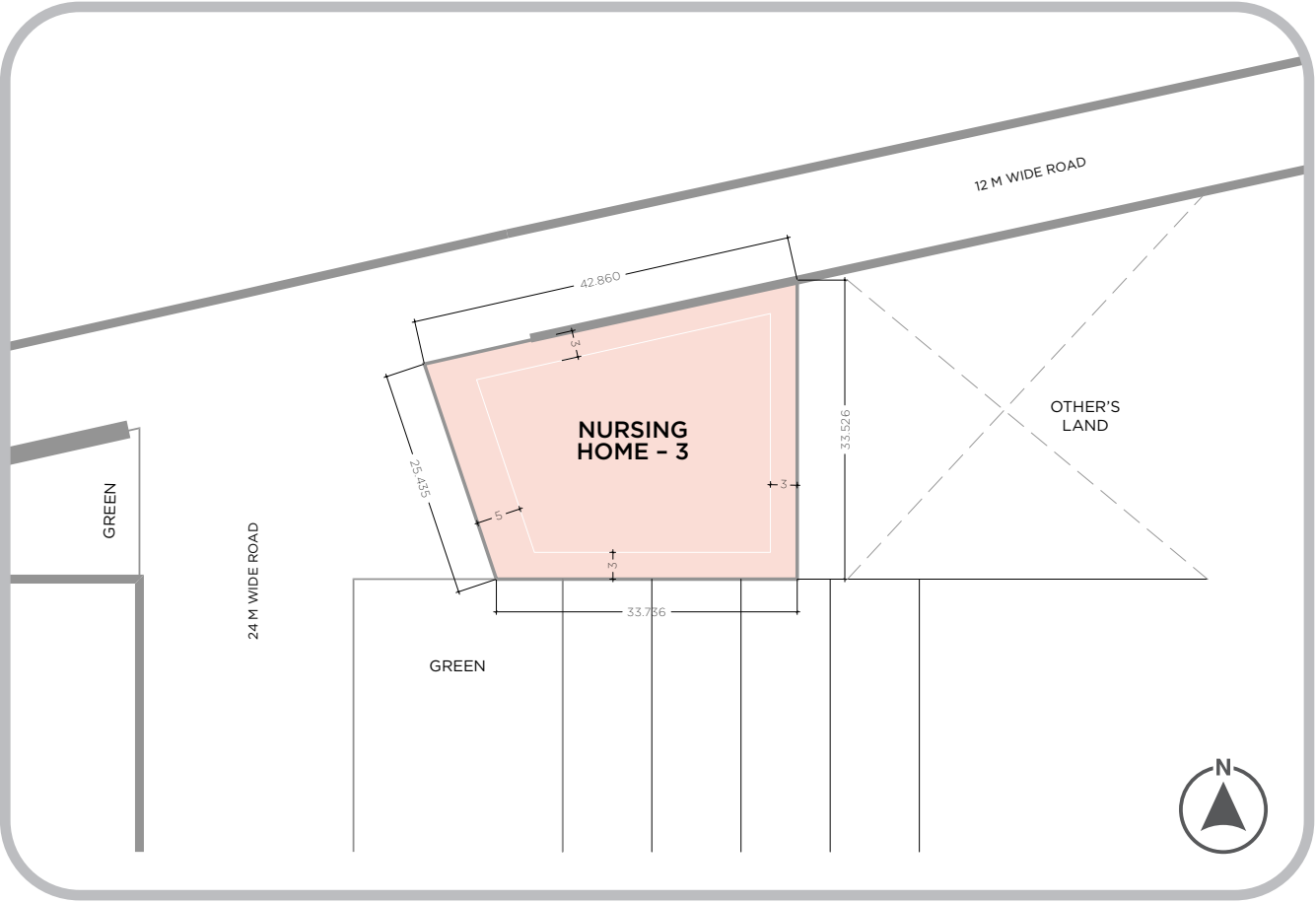

PLOT FOR NURSING HOME - 4
BLOCK - H
TOTAL PLOT AREA = 1,060.28 Sq. m

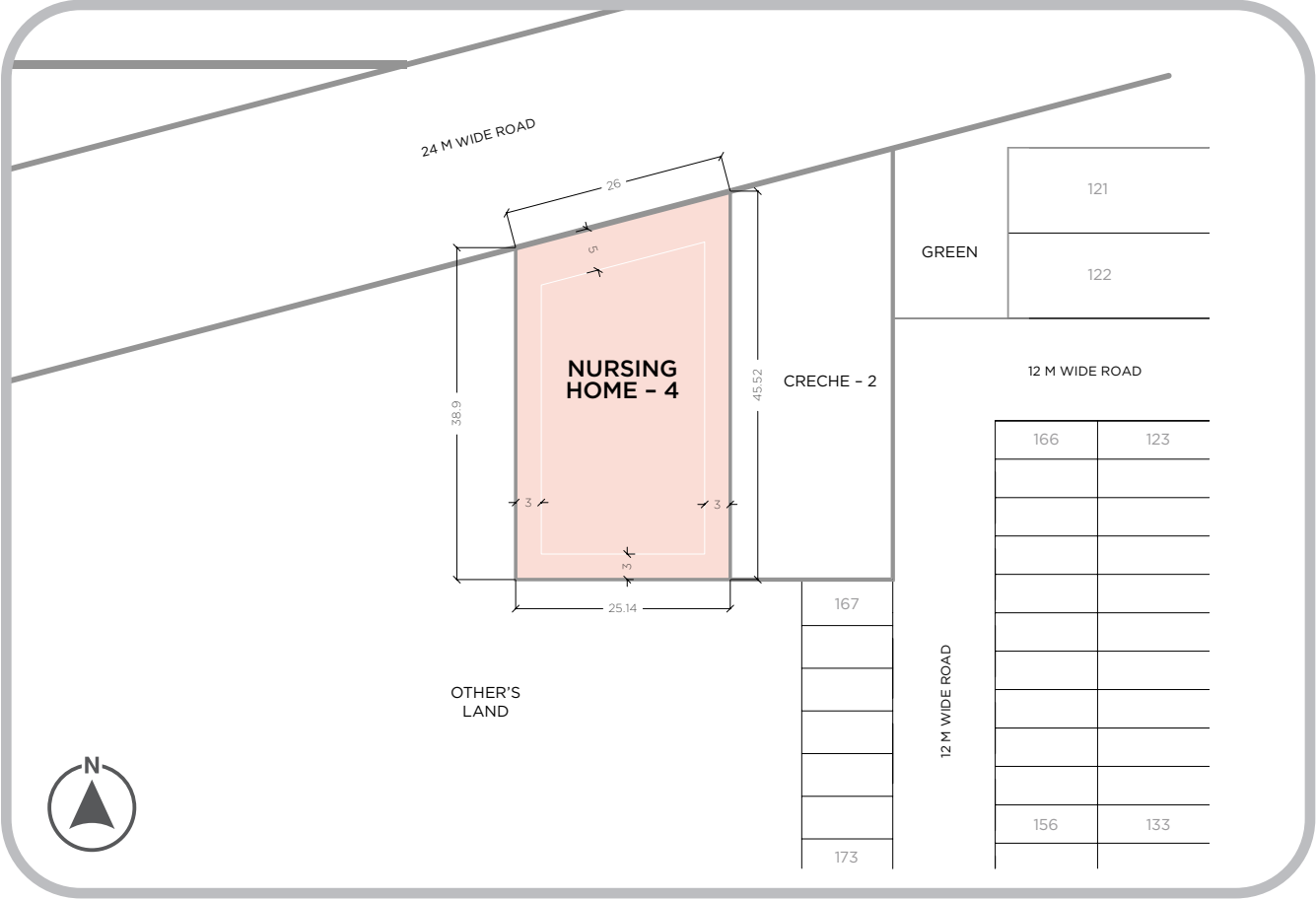
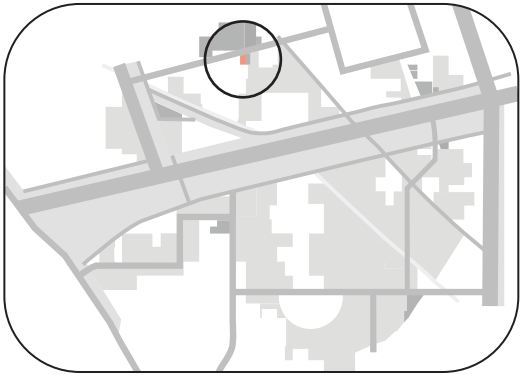

Zoning

approvals received for Jindal Global City

